

PART NUMBER

PFF60-501

DESCRIPTION

FRONT ARM FRONT BUSH

INSTALLATION GUIDE

Contents (parts per pack):

2 x PFF60-501 Bushes 1 x PTFE/Silicone Grease
2 x Stainless Steel Sleeves 2 x Steel Shells

Please read the complete fitting instructions and check package components before fitment. These fitting instructions are to be used as a guide and in conjunction with workshop manual.

It is recommended that:

- all work to be carried out by a licensed technician;
- all safety precautions adhered to;
- wheel alignment to be checked and adjusted as required after any suspension work.
- All fasteners must be tensioned to manufacturer's torque settings.

Fitting Instructions:

1. Remove the original bush from the arm, remembering to clean away any dirt and corrosion. File away any sharp edges using a rounded file.
2. Press the steel outer shell into the arm from as shown in figure 2, ensuring the orientation is correct.
3. Push the polyurethane bushes into the shell until the top lips sits on the shell.
4. Apply some of the supplied grease to the bore of the bushes, and insert the stainless steel sleeve into the bore until it sits flush.
5. Refit the arm to the car, remembering to tension all hardware to manufacturers recommended torque settings.



Figure 1

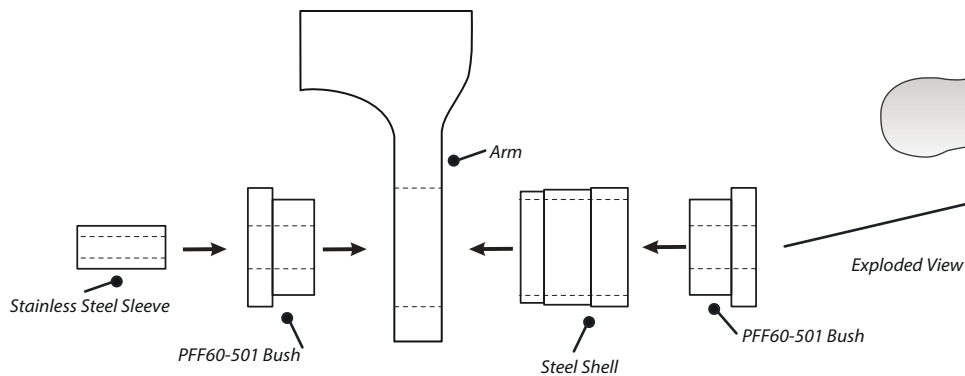

Figure 2