

POWERFLEX®

PART NUMBER

PFF57-1401

DESCRIPTION

Front Wishbone Front Bush

INSTALLATION GUIDE

Contents (parts per pack):

- 2 x Polyurethane Bushes
- 1 x Powerflex Grease

Please read the complete fitting instructions and check package components before fitment. These fitting instructions are to be used as a guide and in conjunction with workshop manual.

It is recommended that:

- all work to be carried out by a licensed technician;
- all safety precautions adhered to;
- wheel alignment to be checked and adjusted as required after any suspension work.
- All fasteners must be tensioned to manufacturer's torque settings.



Fitting Instructions:

1. Remove the wishbone from the car, separate the two halves of the clamping bracket and remove the original bush.
2. Clean any dirt and corrosion from the end of the wishbone and clamping bracket. Remove any burrs or sharp edges using a rounded file.
3. Press the supplied stainless-steel sleeve onto the end of the wishbone, taking note of the machined internal step. The larger inner diameter should be the leading end and pressed onto the arm fully in that direction.
4. Apply the supplied grease to the inside of the bush and slide this onto the sleeve, with the larger lip pressing up against the end of the arm as shown in Fig.1.
5. Reattach the clamping bracket and re-fit the wishbone arm to the car.
6. Tension all hardware to the manufacturers recommended torque settings.

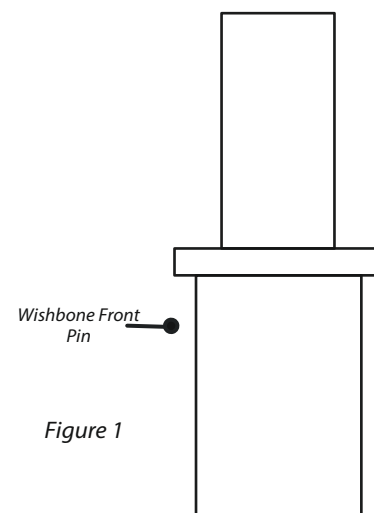
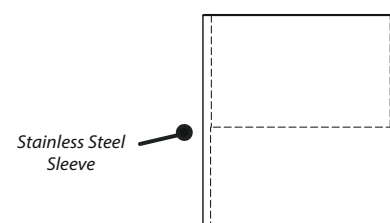
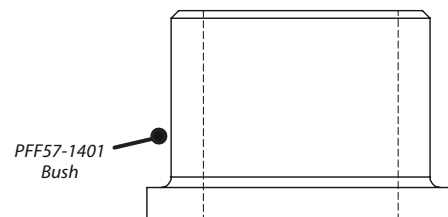

Figure 1