

# POWERFLEX®

## PART NUMBER

# PFF30-323

## DESCRIPTION

## GEARBOX MOUNT FRONT LOWER BUSH

## INSTALLATION GUIDE

### Contents (parts per pack):

- 1 x Polyurethane A Bushes
- 1 x PTFE/Silicone Grease
- 1 x Polyurethane B Bushes
- 1 x Stainless Steel Sleeve
- 1 x Polyurethane B Bushes

Please read the complete fitting instructions and check package components before fitment. These fitting instructions are to be used as a guide and in conjunction with workshop manual.

It is recommended that:

- all work to be carried out by a licensed technician;
- all safety precautions adhered to;
- wheel alignment to be checked and adjusted as required after any suspension work.
- All fasteners must be tensioned to manufacturer's torque settings.



### Fitting Instructions:

1. Remove the OEM bush and outer shell from the bracket.

*Note: The original outer shell MUST BE RETAINED to reinsert.*

2. Clean any dirt and corrosion from the bore of the bracket. Remove any sharp edges from the bore of the bracket.

3. Remove the rubber bush from the outer shell, and insert the original outer shell back into the bore of the bracket as it originally fitted.

4. Push the polyurethane bushes into the bore of the bracket.

*Note: The side of insertion of each polyurethane bush does not affect performance.*

5. Apply some of the supplied grease to the bore and end faces of the bush and push the stainless steel sleeve into the bush bore.

6. Place mild steel washers on the face of each bush.

7. Re-fit the arm to the car. Tension all hardware to manufacturers recommended torque settings.

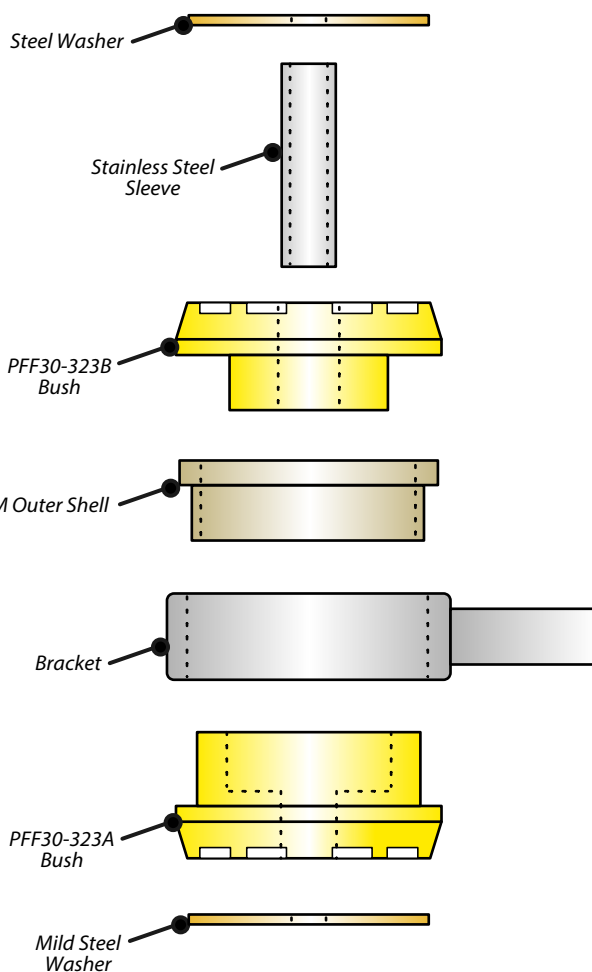

Figure 1